



LIVE GAMER

4K

GC573



English	Polski
Deutsch	Türkçe
Español	Magyar
Français	Русский
Italiano	ภาษาไทย
Português	繁體中文
Čeština	简体中文
Nederlands	한국어

QUICK GUIDE

## Disclaimer

All pictures contained in this documentation are example images only. The images may vary depending on the product and software version. Information presented in this documentation has been carefully checked for reliability; however, no responsibility is assumed for inaccuracies. The information contained in this documentation is subject to change without notice.

## Copyright and Trademark Information

© 2018 by AVerMedia Technologies, Inc. All rights reserved. No part of this publication, in whole or in part, may be reproduced, transmitted, transcribed, altered or translated into any language in any form by any means without the written permission of AVerMedia Technologies, Inc. Information and specification contained in this manual are subject to change without notice and do not represent a commitment on the part of AVerMedia. For more information, please visit [www.avermedia.com](http://www.avermedia.com).

AVerMedia and RECentral are trademarks or registered trademarks of AVerMedia Technologies, Inc.

## Headquarters

Address No.135, Jian 1st Rd., Zhonghe Dist., New Taipei City 23585, Taiwan  
Website [www.avermedia.com](http://www.avermedia.com)  
Support [www.avermedia.com/gaming/technical\\_support](http://www.avermedia.com/gaming/technical_support)  
Telephone +886-2-2226-3630

## US Office

Address 4735B Fremont Blvd., Fremont, CA 94538, United States  
Website [www.avermedia-usa.com](http://www.avermedia-usa.com)  
Telephone +1 (510) 403 0006

## Head Office EU (AVT Solutions GmbH)

Address Hanauer Landstrasse 291 B, 60314 Frankfurt-Hessen, Germany  
Website [www.avermedia.com/gaming/inquiry](http://www.avermedia.com/gaming/inquiry)

## 國際總部

地址 2358 新北市中和區建一路 135 號  
網址 [www.avermedia.com](http://www.avermedia.com)  
支援 [www.avermedia.com/gaming/contact\\_us](http://www.avermedia.com/gaming/contact_us)  
電話 +886-2-2226-3630

## 中国子公司

地址 上海市静安区武宁南路 488 号智慧广场 1510 室  
网址 [www.avermedia.com.cn](http://www.avermedia.com.cn)  
电话 +86-21-52987985

## Important Safety Instructions

1. Read these instructions.
2. Keep these instructions.
3. Follow all instructions.
4. Heed all warnings.
5. Do not use the apparatus on uneven or unstable surfaces.
6. Do not use this apparatus in a wet environment or near water.
7. Unplug the apparatus before cleaning. Clean only with a dry cloth.
8. Use in a well ventilated environment. Do not block any ventilation openings.

9. Use the apparatus within ambient temperatures 32 - 104°F [0 - 40°C].
10. Use power sources within the specified voltage range.
11. Do not place heavy objects on the apparatus.
12. Do not install near heat sources such as radiators or stoves.
13. Do not defeat the safety purposes of the polarized or grounding-type plug.
14. Protect the power cord from being walked on or pinched, particularly where the cord connects with plugs or adapters.
15. Only use the attachments and accessories specified by the manufacturer.
16. Unplug this apparatus during lightning or when unused for prolonged periods of time.
17. Do not modify or disassemble the apparatus in any way.
18. Refer all servicing to AVerMedia Customer Service.
19. Do not dispose the apparatus as general household waste. Dispose in accordance with local environmental laws.

## 重要安全說明

1. 仔細閱讀這些說明。
2. 妥善保存這些說明。
3. 遵守所有的指示。
4. 注意所有的警告。
5. 請勿將本產品安裝於不平整的表面。
6. 請勿在潮濕或靠近水的地方使用本產品。
7. 清潔前請拔除電源，僅使用乾布清潔。
8. 請於通風的環境使用本產品，請勿堵住通風口。
9. 請於規格溫度範圍 32 - 104°F [0 - 40°C] 使用本產品。
10. 請使用額定電壓範圍內的電源。
11. 請勿放置重物於本產品上。
12. 請勿安裝於熱源附近如暖器或火爐旁。
13. 請勿破壞極性或接地插頭的安全防護設計。
14. 請保護電源線，勿使其被踩踏或碾壓，特別是與插頭或變壓器的連接處。
15. 僅使用製造商指定的配件及零件。
16. 打雷或長時間不使用時請拔除電源。
17. 請勿以任何方式改造或拆解本產品。
18. 如需維修請洽本公司客服人員。
19. 請勿當作家庭垃圾任意丟棄，請遵從當地環境法規妥善處理。

## 重要安全说明

1. 仔细阅读这些说明。
2. 妥善保存这些说明。
3. 遵守所有的指示。
4. 注意所有的警告。
5. 请勿将本产品安装于不平整的表面。
6. 请勿在潮湿或靠近水的地方使用本产品。
7. 清洁前请拔除电源，仅使用干布清洁。
8. 请于通风的环境使用本产品，请勿堵住通风口。
9. 请于规格温度范围 32 - 104°F [0 - 40°C] 使用本产品。
10. 请使用额定电压范围内的电源。
11. 请勿放置重物于本产品上。
12. 请勿安装于热源附近如暖器或火炉旁。
13. 请勿破坏极性或接地插头的安全防护设计。
14. 请保护电源线，勿使其被踩踏或碾压，特别是与插头或变压器的连接处。
15. 仅使用制造商指定的配件及零件。
16. 打雷或长时间不使用时请拔除电源。
17. 请勿以任何方式改造或拆解本产品。
18. 如需维修请洽本公司客服人员。
19. 请勿当作家庭垃圾任意丢弃，请遵从当地环境法规妥善处理。

## ► PREPARATION

### Inside the Box

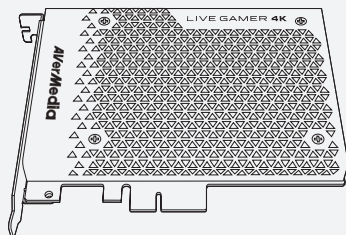

Live Gamer 4K

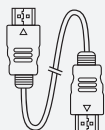

HDMI 2.0 Cable



Quick Guide



PowerDirector 15  
Product Key Card

### Ports

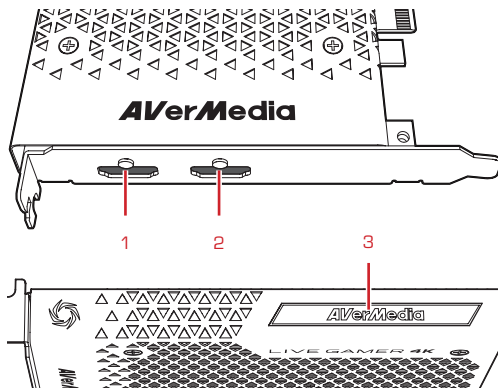

- |   |                                 |
|---|---------------------------------|
| 1 | HDMI Output Port (Pass-Through) |
| 2 | HDMI Input Port                 |
| 3 | LED Indicator                   |

## ▶ INSTALLATION

### LG4K

1. Insert LG4K to a PCIe x4 Gen 2 slot in your PC
2. Connect your monitor to the HDMI-OUT port for pass-through of captured content
3. Connect your video source (console / graphics card / another PC) to the HDMI-IN port

### RECentral

RECentral is the default streaming/recording software designed for Live Gamer capture cards. It also includes settings for the LG4K's lighting effects.

Download it from: [q.avermedia.com/gc573-RECentral](http://q.avermedia.com/gc573-RECentral)

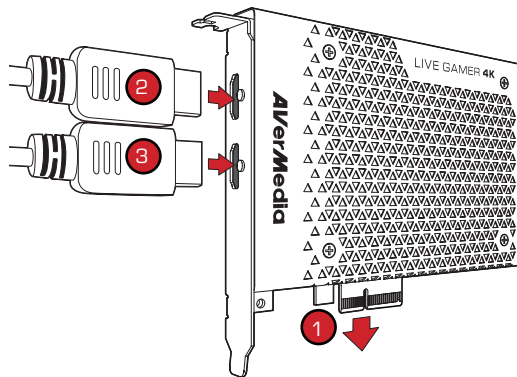

## ▶ LED INDICATIONS

Solid Blue / RGB Effects	Ready
Slow Flashing Red	Recording
Slow Flashing Blue	Streaming
Fast Flashing Red	Disk Almost Full
Solid Red	Disk Full
Flashing Red	Error: Streaming or Recording Stopped
Flashing Red	Error: Device Anomaly

## ► SPECIFICATIONS

Interface	PCI Express x4 Gen 2
Input & Output (Pass-Through)	HDMI 2.0
Max. Capture Resolution	2160p60 HDR/1440p120/1080p240
Supported Resolution	2160p, 1440p, 1080p, 1080i, 720p, 576p, 480p
Max. Pass-Through Resolution	2160p60 HDR/1440p144/1080p240
Record Format	MPEG 4 (H.264 + AAC) or (H.265 + AAC)*
Dimensions (W x D x H)	125 x 151 x 21.5 mm
Weight	208 g

\*H.265 compression and HDR recording are supported by RECcentral

Note: Specifications are subject to change without notice. Please refer to our website for the latest details.

## Magyar

### ELŐKÉSZÍTÉS

Mi van a dobozban

- Live Gamer 4K
- HDMI-2.0-kábel
- Gyors útmutató
- PowerDirector 15 termék kulcskártya

Részegységek és portok

1. HDMI kimeneti csatlakozó (továbbítás)
2. HDMI bemeneti csatlakozó
3. LED jelző

### TELEPÍTÉS

#### LG4K

1. Helyezze be az LG4K kártyát egy PCIe x4 Gen 2 nyílásba a számítógépen
2. Csatlakoztasson egy monitort a HDMI-OUT csatlakozóhoz a rögzített tartalom továbbításához
3. Csatlakoztasson egy videoforrást (konzol / videokártya / másik számítógép) a HDMI-IN csatlakozóhoz

#### RECentral

A RECentral az alapértelmezett adatfolyam-kezelő / rögzítő szoftver a Live Gamer rögzítőkártyákhoz. Beállítását tartalmaz az LG4K világítás effektusokhoz. Töltse le innen: [q.avermedia.com/gc573-recentral](http://q.avermedia.com/gc573-recentral)

### LED KIJELZÉSEK

- Folytonos kék / RGB effektusok: Kész
- Lassan villogó piros: Rögzítés
- Lassan villogó kék: Adatfolyam továbbítása
- Gyorsan villogó piros: Lemez majdnem tele
- Folyamatos piros: Lemez tele / Hiba: adatfolyam vagy rögzítés leállítva
- Villogó piros: Hiba: Eszköz anomália

## Русский

### ПОДГОТОВКА

#### Внутри коробки

- Live Gamer 4K
- Кабель HDMI 2.0
- Краткое пособие
- Ключ для PowerDirector 15

#### Элементы и Порты

1. Выход HDMI (сквозной)
2. Вход HDMI
3. Световой индикатор

### УСТАНОВКА

#### LG4K

1. Вставьте LG4K в слот PCIe x4 Gen 2 в вашем компьютере
2. Подключите монитор к порту HDMI-OUT для сквозного захвата контента
3. Подключите источник видеосигнала (консоль / видеокарта / другой ПК) к порту HDMI-IN

#### RECentral

RECentral это программа по умолчанию для потокового вещания / записи, предназначенная для карт захвата серии Live Gamer. Включает настройки световых эффектов LG4K. Загрузить его можно с: [q.avermedia.com/gc573-recentral](http://q.avermedia.com/gc573-recentral)

### СВЕТОДИОДНАЯ ИНДИКАЦИЯ

- Горит синий: Готов
- Медленно мигает красный: Запись
- Медленно мигает синий: Стрим
- Быстро мигает красный: Диск почти заполнен
- Горит красный: Диск заполнен / Ошибка: Стрим или запись остановлены
- Мигает красный: Ошибка: Устройство не готово

## ภาษาไทย

### การเตรียมการ

#### ภายในกล่อง

- Live Gamer 4K
- สาย HDMI 2.0
- คู่มือใช้งานเบื้องต้น
- การ์ดคีย์ผลิตภัณฑ์ PowerDirector 15

#### ชิ้นส่วนและพอร์ต

1. สัญญาณ HDMI ขาออก
2. สัญญาณ HDMI ขาเข้า
3. ไฟสถานะ LED

### การติดตั้ง

#### LG4K

1. ใส่ LG4K ลงในสล็อต PCIe x4 Gen 2 ในเครื่องคอมพิวเตอร์ของคุณ
2. เชื่อมต่อจอภาพเข้ากับพอร์ต HDMI-OUT เพื่อส่งผ่านข้อมูลที่ถ่าย
3. เชื่อมต่อแหล่งสัญญาณภาพ (คอนโซล / การ์ดกราฟิก / พีซีเครื่องอื่น) เข้ากับพอร์ต HDMI-IN

#### RECentral

RECentral เป็นซอฟต์แวร์สตรีมมิง / บันทึกภาพที่ได้รับการออกแบบมาสำหรับการ์ดจับภาพ Live Gamer นอกจากนี้ยังมีการตั้งค่าสำหรับเอฟเฟกต์แสงของ LG4K. ดาวน์โหลดได้จาก: [q.avermedia.com/gc573-recentral](http://q.avermedia.com/gc573-recentral)

### การมีสีสถานะของ LED

- สีน้ำเงิน / เอฟเฟกต์ RGB: พร้อมใช้งาน
- สีแดงกระพริบช้าๆ: กำลังบันทึก
- สีน้ำเงินกระพริบช้าๆ: กำลังสตรีมมิง
- สัญญาณไฟแดงกระพริบอย่างรวดเร็ว: ที่เก็บข้อมูลใกล้จะเต็ม
- สัญญาณไฟแดงค้าง: ที่เก็บข้อมูลเต็ม / ผิดพลาด: การสตรีมและการบันทึกหยุดการทำงาน
- สัญญาณไฟแดงกระพริบ: ผิดพลาด: อุปกรณ์ทำงานผิดปกติ



## Federal Communications Commission Statement

### Class B

This device complies with Part 15 of the FCC Rules. Operation is subject to the following two conditions: [1] this device may not cause harmful interference, and [2] this device must accept any interference received, including interference that may cause undesired operation.

NOTE - This equipment has been tested and found to comply with the limits for a Class B digital device, pursuant to Part 15 of the FCC Rules. These limits are designed to provide reasonable protection against harmful interference in a residential installation. This equipment generates, uses and can radiate radio frequency energy and, if not installed and used in accordance with the instructions, may cause harmful interference to radio communications. However, there is no guarantee that interference will not occur in a particular installation. If this equipment does cause harmful interference to radio or television reception, which can be determined by tuning the equipment off and on, the user is encouraged to try to correct the interference by one or more of the following measures:

- Reorient or relocate the receiving antenna.
- Increase the separation between the equipment and receiver.
- Connect the equipment into an outlet on a circuit different from that to which the receiver is connected.
- Consult the dealer or an experienced radio/television technician for help.

### CAUTION ON MODIFICATIONS

To comply with the limits for the Class B digital device, pursuant to Part 15 of the FCC Rules, this device must be installed in computer equipment certified to comply with the Class B limits. All cables used to connect the computer and peripherals must be shielded and grounded. Operation with non-certified computers or non-shielded cables may result in interference to radio or television reception.

Changes and modifications not expressly approved by the manufacturer or registrant of the equipment can void your authority to operate the equipment under Federal Communications Commission rules.

## CAN ICES-3 (B)/NMB-3(B)

### Canada - Canada Industry Canada (IC) Labelling Requirements

Every manufacturer or importer shall ensure import or before offering for sale, as appropriate, that each unit of the type that they offer for sale bears, in allocation convenient for inspection, a permanent label or marking containing (in French and English), the following statement:

ICES-003 (Interference - Causing Equipment Standards)

"This class B digital apparatus complies with Canadian ICES-003.

Cet appareil numérique de la classe B est conforme à la norme NMB-003 du Canada."



## Technical Regulations of the Customs Union

TR CU 020/2011

TR CU 004/2011



## BSMI Registration of Product Certification (Taiwan)

【圖剛 BSMI 限用物質及其化學符號】放置於公司企業社會責任專頁

網址 [http://www.evermedia.com/tw/about\\_us/social](http://www.evermedia.com/tw/about_us/social)

D33183  
RoHS



## MSIP Class B Statement (Korea)

R-REM-AVM-GC573



## Regulatory Compliance Mark



## European Community Compliance Statement

### Class B

This product is herewith confirmed to comply with the requirements set out in the Council Directives on the approximation of the laws of the Member States relating to Electromagnetic Compatibility Directive (EMC) 2014/30/EU



## Waste Electrical and Electronic Equipment Directive

The mark of crossed-out wheeled bin indicates that this product must not be disposed of with your other household waste. Instead, you need to dispose of the waste equipment by handing it over to a designated collection point for the recycling of waste electrical and electronic equipment. For more information about where to drop off your waste equipment for recycling, please contact your household waste disposal service or the shop where you purchased the product.

300AGC573EAP

GC573

Live Gamer 4K

Capture Card/擷取卡/游戏直播卡

Made in Taiwan/台灣製造/台湾制造



[www.avermedia.com](http://www.avermedia.com)