

# JBL ONBEAT MINI

## QUICK-START GUIDE



Made for



iPod



iPhone



iPad

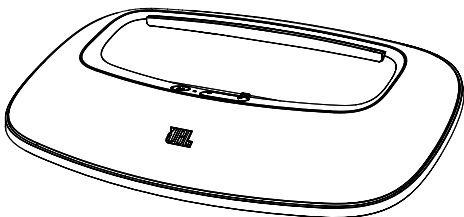

1x

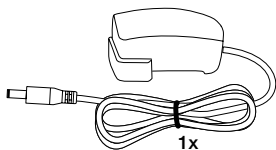

1x



1x

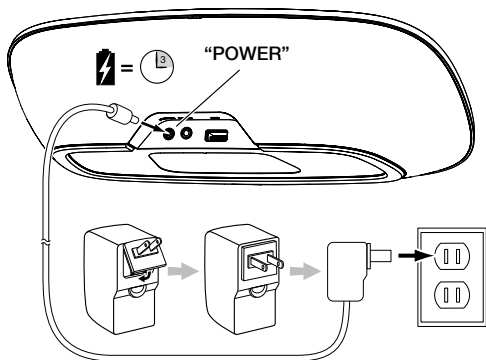

Made for  
iPhone 5  
iPad mini  
iPad (4th generation)  
iPod touch (5th generation)  
iPod nano (7th generation)

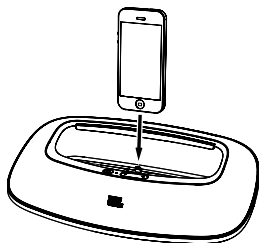

Made for  
iPhone 4S  
iPhone 4  
iPhone 3GS  
iPhone 3G  
iPod touch (2nd, 3rd  
and 4th generation)  
iPod nano (2nd through  
6th generation)

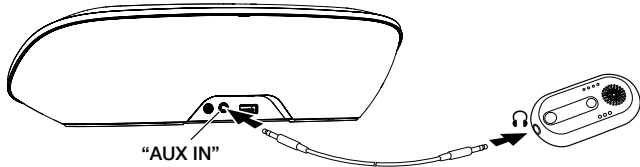
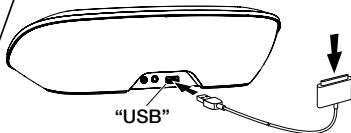

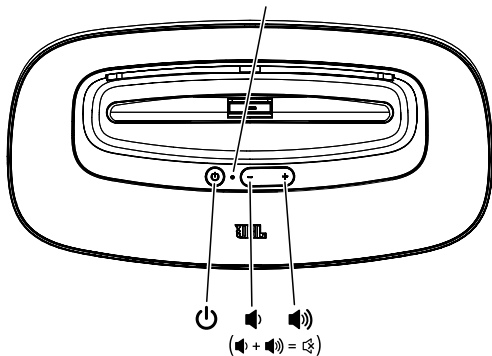
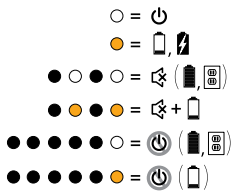

## WHEN ON BATTERY POWER:

- The JBL OnBeat Mini will automatically enter the Standby mode after it detects no audio signal for 5 minutes (after 10 minutes when on AC power). Upon detecting an audio signal the system will turn on and play audio.
- The JBL OnBeat Mini will not charge a docked iPhone.

## EN CAS DE FONCTIONNEMENT SUR PILES :

- Le JBL OnBeat Mini entrera automatiquement en mode Veille après n'avoir détecté aucun signal audio pendant 5 minutes (après 10 minutes en cas d'alimentation secteur). Dès qu'il détectera un signal audio, le système s'allumera et jouera le contenu audio.
- Le JBL OnBeat Mini ne chargera pas un iPhone inséré dans sa station d'accueil.

## LORSQUE LA BATTERIE:

- Das JBL OnBeat Mini wechselt automatisch in den Standby-Modus, wenn es 5 Minuten lang kein Signal empfängt (nach 10 Minuten bei Netzteilversorgung). Beim Empfang eines Audio-Signals schaltet sich das System ein und gibt das Signal wieder.
- Das JBL OnBeat Mini dient nicht als Ladestation für ein aufgestecktes iPhone.

## CON ALIMENTAZIONE A BATTERIA:

- Il JBL OnBeat Mini entrerà automaticamente in modalità Standby dopo non aver individuato alcun segnale audio per 5 minuti (dopo 10 minuti con alimentazione di rete). In presenza di segnale audio, il sistema si accenderà e suonerà l'audio.
- The JBL OnBeat Mini non caricherà l'iPhone inserito nel dock.

## AL ESTAR EN MODO DE ENERGIA DE BATERIAS:

- El JBL OnBeat Mini automaticamente entrara en modo Standby despues de que no detecte sonido por mas de 5 minutos (despues de 10 minutos cuando se use con corriente alterna). Al detectar sonido el sistema Saldra del modo standby y reproducira el sonido.
- El JBL OnBeat Mini no cargara el iPhone en la base.

## NO MODO STANDBY:

- JBL OnBeat Mini ficará no modo Standby depois de 5 minutos de no perceber som. (depois de 10 minutos quando usa o cabo CA) Quando o dispositivo detectar o som, voltará tocar a musica.
- JBL OnBeat Mini nao carregará o iPhone na base.

## 電池使用時:

- 音声信号が5分以上（AC電源使用時は10分以上）検出されない場合、JBL OnBeat Miniは自動的にスタンバイモードに入ります。音声信号を検出すると、システムを起動し音声を再生します。
- JBL OnBeat Miniでは、接続したiPhoneの充電はできません。

## 배터리 전력일 때:

- JBL OnBeat Mini는 5분 동안 아무 오디오 신호를 감지하지 않으면 자동으로 대기모드에 들어갑니다 (AC 전원일 때는 10분 후). 오디오 신호를 감지하면 시스템이 켜지고 오디오를 재생합니다.
- JBL OnBeat Mini는 도킹된 아이폰을 충전하지 않습니다.

## 电池模式下：

- JBL OnBeat Mini 在无法检测到音频信号 5 分钟后（使用 AC 电源 10 分钟后），会自动进入待机模式。检测到音频信号后，系统将启动并播放音频。
- JBL OnBeat Mini 无法为置于基座上的 iPhone 进行充电。

## IN DE BATTERIJMODUS:

- De JBL OnBeat Mini schakelt automatisch over naar de Standby-stand als er geen audiosignaal wordt gedetecteerd gedurende 5 minuten (10 minuten met AC-adapter). Zodra er een audiosignaal wordt gedetecteerd, gaat het systeem aan en speelt het de audio af.
- De JBL OnBeat Mini laadt geen gedockte iPhone op.

## NÅR DEN ER PÅ BATTERISTRØM:

- JBL OnBeat Mini vil automatisk entre standby-modus dersom den ikke oppdager lydsignaler i løpet av 5 minutter (etter 10 minutter når den er på AC-strøm). Når systemet oppdager et lydsignal, vil det slås på og spille av lyd.
- JBL OnBeat Mini vil ikke lade en dokket iPhone.

## AKKUKÄYTTÖISENÄ:

- JBL OnBeat Mini asettautuu automaattisesti lepotilaan kun audio-signaalia ei ole havaittu 5:n minuutin kuluessa (10 minuuttia AC-virran ollessa kytkettynä). Havaittaessa audio-signaali järjestelmä kytkeytyy päälle ja toistaa audion.
- JBL OnBeat Mini ei lataudu telakoidussa iPhonessa.

## ПРИ РАБОТЕ ОТ БАТАРЕИ:

- При отсутствии звукового сигнала в течение 5 минут система “JBL OnBeat Mini” автоматически перейдёт в режим ожидания (при питании от переменного тока — через 10 минут). При возобновлении сигнала система включится и начнёт проигрывать звук.
- Система “JBL OnBeat Mini” не заряжает Айфон, поставленный на док-станцию.

## VID BATTERIFÖRSÖRJNING:

- JBL OnBeat Mini kommer att övergå till Standby-läge automatiskt efter att inte ha detekterat någon ljudsignal under 5 minuter (efter 10 minuter vid nätförsörjning). Vid detektering av ljudsignal, kommer systemet att sättas igång och spela upp ljudet.
- JBL OnBeat Mini kommer inte att ladda en dockad iPhone.

## NÅR APPARATET KØRER PÅ STRØM FRA BATTERI:

- JBL OnBeat Mini vil automatisk gå i dvaletilstand, hvis det ikke opfanger et lyd-signal efter 5 minutter (efter 10 minutter, når apparatet er i stik). Når systemet opfanger et lyd-signal, vil det automatisk tænde og afspille lyd.
- JBL OnBeat Mini oplader ikke en dokket iPhone.

## SPECIFICATIONS

---

Transducers:	2 x JBL full-range transducers
Amplifier power:	7 watts x 2 (AC power); 3.5 watts x 2 (battery power)
Frequency response:	20Hz – 20kHz
Signal-to-noise ratio:	84dB
Battery type:	Lithium polymer (7.4V, 2000mAh)
Power requirement:	13V DC; 3.23A
Power consumption:	42W (maximum); <1.0W (battery maintenance mode)
Dimensions (H x W x D):	3-1/2" x 12" x 6-3/16" (88mm x 305mm x 157mm)
Weight:	1.78 lb (0.81kg)

---

## SPECIFICATIONS

---

Chassis:	2 x JBL Vollbereichs-Chassis
Ausgangsleistung:	7 watt x 2 (AC power); 3.5 watt x 2 (battery power)
Frequenzbereich:	20Hz – 20kHz
Rauschabstand:	84dB
Batterie Typ:	Lithium polymer (7.4V, 2000mAh)
Strombedarf:	13V DC, 3.23A
Leistungsaufnahme:	42W (maximal); <1.0W (battery maintenance mode)
Maße (T x B x H):	88mm x 305mm x 157mm (3-1/2" x 12" x 6-3/16")
Gewicht:	0,81kg (1,78 lb)

---

## CARACTERISTIQUES TECHNIQUES

---

Transducteurs:	2 haut-parleurs JBL
Puissance:	7 watts x 2 (AC power); 3.5 watts x 2 (battery power)
Reponse en frequence:	20Hz – 20kHz
Rapport signal-bruit:	84dB
Piles type:	Lithium polymer (7.4V, 2000mAh)
Exigence de puissance:	13V DC, 3.23A
Consommation electrique:	22W (maximum); <1.0W (battery maintenance mode)
Dimensions (P x L x H):	88mm x 305mm x 157mm (3-1/2" x 12" x 6-3/16")
Poids:	0.81kg (1.78 lb)

---

## SPECIFICHE TECNICHE

---

Trasduttore:	2 Trasduttore a pieno regime JBL
Potenza:	7 watt x 2 (AC power); 3.5 watt x 2 (battery power)
Risposta in frequenza:	20Hz – 20kHz
Rapporto segnale/rumore:	84dB
Tipo batteria:	Lithium polymer (7.4V, 2000mAh)
Requisiti di alimentazione:	13V DC, 3.23A
Consumo Energia:	42W (massimo) <1.0W (battery maintenance mode)
Dimensioni (P x L x H):	88mm x 305mm x 157mm (3-1/2" x 12" x 6-3/16")
Peso:	0.81kg (1.78 lb)

---



## ESPECIFICACIONES

---

Potencia:	2 transductores JBL de gama completa
Respuesta de Frecuencia:	7W x 2 (AC power); 3.5W x 2 (battery power)
Relación señal ruido	20Hz – 20kHz
Impedancia de entrada (Aux):	84dB
Tipo de pilas:	Lithium polymer (7.4V, 2000mAh)
Requisitos eléctricos:	13V DC, 3.23A
Consumo de potencia:	42W (maximo); <1.0W (battery maintenance mode)
Dimensiones (Al x An x Pr):	88mm x 305mm x 157mm
Peso:	0.81kg

---

## TECHNISCHE GEGEVENS

---

Omvormers:	2 x JBL full-range transducers
Belastbaarheid:	7 watts x 2 (AC power); 3.5 watts x 2 (battery power)
Frequentiebereik:	20Hz – 20kHz
Signaal/ruis-afstand:	84dB
Batterij soort:	Lithium polymer (7.4V, 2000mAh)
Stroomvereisten:	13V DC, 3.23A
Stroomverbruik:	42W (maximum); <1.0W (battery maintenance mode)
Afmetingen (D x B x H):	88mm x 305mm x 157mm (3-1/2" x 12" x 6-3/16")
Gewicht:	0.81kg (1.78 lb)

---

## SPECIFIKATIONER

---

Omvandlere:	2 x JBL fullregister element
Stromforsyning:	7 watt x 2 (AC power); 3.5 watt x 2 (battery power)
Frekvensomfang:	20Hz – 20kHz
Signal-till-brus-forhallande:	84dB
Batteri typ:	Lithium polymer (7.4V, 2000mAh)
Stromspecifikationer:	13V DC, 3.23A
Energiforbrukning:	42W (maximum); <1.0W (battery maintenance mode)
Matt (D x B x H):	88mm x 305mm x 157mm (3-1/2" x 12" x 6-3/16")
Vikt:	0,81kg

---

## SPECIFIKATIONER

---

Transducere:	2 x JBL full-range transducere
Strøm:	7 watt x 2 (AC power); 3.5 watt x 2 (battery power)
Frekvensgang:	20Hz – 20kHz
Signal/Støj Forhold:	84dB
Batteritype:	Lithium polymer (7.4V, 2000mAh)
Strømkrav:	13V DC (jævnstrøm), 3.23A
Strømforbrug:	42W (maksimum); <1.0W (battery maintenance mode)
Mal (D x B x H):	88mm x 305mm x 157mm (3-1/2" x 12" x 6-3/16")
Vægt:	0.81kg (1.78 lb)

---

## TEKNISET TIEDOT

Kaiutinelementit:	2 x JBL kokoaanialueen elementtia.
Virta:	7 wattia x 2 (AC power); 3.5 wattia x 2 (battery power)
Taajuusvaste:	20Hz – 20kHz
Signaali-kohinasuhde:	84dB
Akun tyyppi:	Lithium polymer (7.4V, 2000mAh)
Tehovaatimukset:	13V DC, 3.23A
Virrankulutus:	42W (maksimi); <1.0W (battery maintenance mode)
Mitat (S x L x K):	88mm x 305mm x 157mm (3-1/2" x 12" x 6-3/16")
Paino:	0,81kg

## СПЕЦИФИКА ЦИЯ

Динамики:	2 x JBL широкополосных динамика
Мощность:	7 Вт x 2 (AC power); 3.5 Вт x 2 (battery power)
Частотная характеристика:	20Гц – 20кГц
Отношение сигнал/шум:	84дБ
Размер батареек:	Lithium polymer (7.4V, 2000mAh)
Питание:	13 Вольт постоянного тока, 3,23 А
Потребляемая мощность:	42Вт (максимум); <1.0Вт (battery maintenance mode)
Габариты (Г x Ш x В):	88mm x 305mm x 157mm
Вес:	0,81 кг (1,78 фунтов)

## SPESIFIKASJONER

---

Strømomformere:	2 x JBL fullskala forsterkere
Effekt:	7 watts x 2 (AC power); 3.5 watts x 2 (battery power)
Frekvenssvar:	20Hz – 20kHz
Forholdet signal-til-støy:	84dB
Batteritype:	Lithium polymer (7.4V, 2000mAh)
Power requirement:	13V DC, 3.23A
Power consumption:	42W (maksimum); <1.0W (battery maintenance mode)
Dimensions (H x W x D):	88mm x 305mm x 157mm (3-1/2" x 12" x 6-3/16")
Vekt:	0.81kg

---

## ESPECIFICAÇÕES

---

Transdutores:	2 x JBL full-range transducers
Alimentacao:	7 watts x 2 (AC power); 3.5 watts x 2 (battery power)
Resposta frequencia:	20Hz – 20kHz
Relacao sinal/ruído:	84dB
Tipo da bateria:	Lithium polymer (7.4V, 2000mAh)
Requisitos da alimentacao:	13V DC, 3.23A
Consumo de energia:	42W (maximo); <1.0W (battery maintenance mode)
Dimensoes (P x L x A):	88mm x 305mm x 157mm (3-1/2" x 12" x 6-3/16")
Peso:	1,78 lb (0,81kg)

---

## 产品规格

传感器 (单元) :	2 x JBL全频单元
功率:	7 瓦特 x 2 (AC power); 3.5 瓦特 x 2 (battery power)
频率响应:	20赫兹至20千赫兹
信噪比:	84分贝
电池类型:	Lithium polymer (7.4V, 2000mAh)
电源要求:	13伏直流, 3.23安
功耗:	42W (最大); <1.0W (battery maintenance mode)
尺寸 (深 x 宽 x 高) :	88毫米 x 305毫米 x 157毫米 (3-1/2英寸 x 12英寸 x 6-3/16英寸)
重量:	1.78磅 (0.81公斤)

## 사양

변환기:	2 x JBL 풀 레인지 변환기
앰프 파워:	7 와트 x 2 (AC power); 3.5 와트 x 2 (battery power)
주파수 응답:	20Hz – 20kHz
신호 대 잡음 비:	84dB
배터리 종류:	Lithium polymer (7.4V, 2000mAh)
전력 요구량:	13V DC, 3.23A
전력 소비:	42W (최대); <1.0W (battery maintenance mode)
면적 (H x W x D):	3-1/2" x 12" x 6-3/16" (88mm x 305mm x 157mm)
무게:	1.78 lb (0.81kg)

## 仕様

トランスジューサー:	2 x JBL フルレンジトランスジューサー
電源:	7 ワット x 2 (AC power); 3.5 ワット x 2 (battery power)
周波数応答:	20Hz - 20kHz
信号対雑音比:	84dB
電池のサイズと形式:	Lithium polymer (7.4V, 2000mAh)
電源要件:	直流13ボルト、3.23A
消費電流:	42W (最大); <1.0W (battery maintenance mode)
寸法 (奥行x幅x高さ):	88mm x 305mm x 157mm (3-1/2 x 12 x 6-3/16インチ)
重量:	1.78 lb (0.81kg)



**HARMAN** HARMAN International Industries, Incorporated  
8500 Balboa Boulevard, Northridge, CA 91329 USA

© 2013 HARMAN International Industries, Incorporated. All rights reserved. JBL is a trademark of HARMAN International Industries, Incorporated, registered in the United States and/or other countries.

iPad, iPhone, iPod, iPod nano, and iPod touch are trademarks of Apple Inc., registered in the U.S. and other countries. Lightning is a trademark of Apple Inc. iPod/iPhone / iPad not included.

"Made for iPod," "Made for iPhone," and "Made for iPad" mean that an electronic accessory has been designed to connect specifically to iPod, iPhone, or iPad, respectively, and has been certified by the developer to meet Apple performance standards. Apple is not responsible for the operation of this device or its compliance with safety and regulatory standards. Please note that the use of this accessory with iPod, iPhone, or iPad may affect wireless performance. Features, specifications and appearance are subject to change without notice.

Part No. JBLP5307 Rev. A

[www.jbl.com](http://www.jbl.com)