

# RIG 500 SERIES

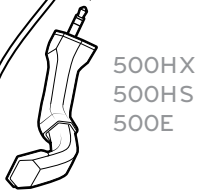

500HX  
500HS  
500E

500HD  
500E

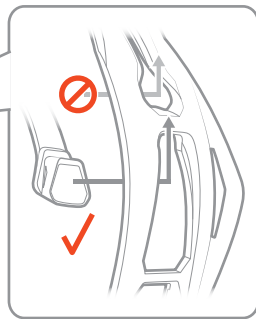

- PS4 only
- 1 Settings > Sound and Screen > Audio Output Settings > Output to Headphones > Select All Audio
  - 2 Settings > Devices > Audio Devices > Headsets and Headphones > Volume Control (Headphones) > 🔊

plantronics.com/support/RIG500



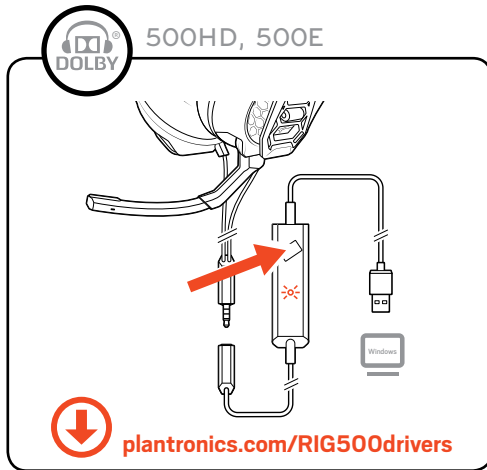
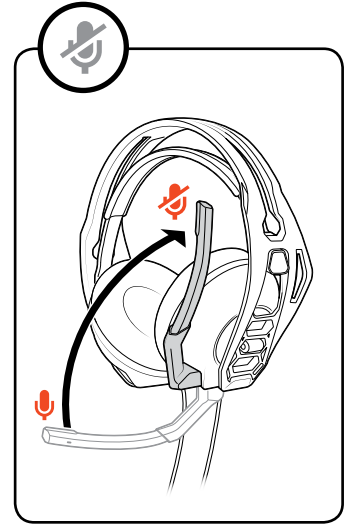
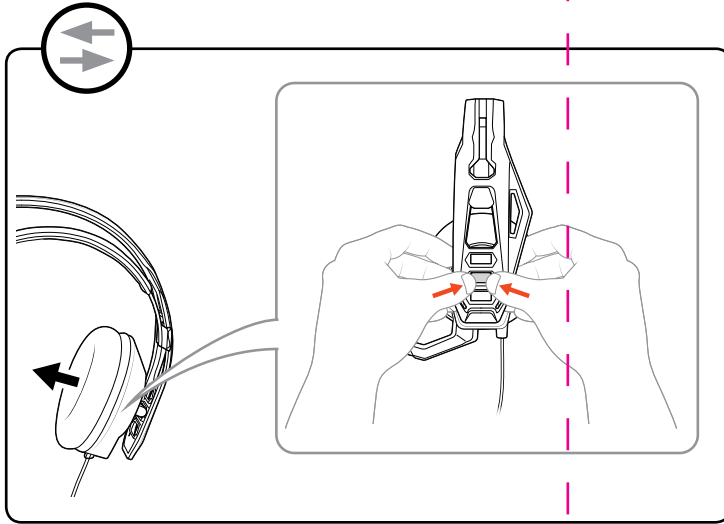

plantronics®  
GAMING

## RIG 500 SERIES

### QUICK START GUIDE

GUIDE DE DÉMARRAGE RAPIDE

© 2015 Plantronics, Inc. Plantronics and RIG are trademarks of Plantronics, Inc. registered in the US and other countries. The double-D symbol is a trademark of Dolby Laboratories. All other trademarks are the property of their respective owners.

Patents pending.  
204096-01 05.15



# plantronics®

Project: **RIG 500 series QSG**

Date: **05.22.15**

Component: **folded**

File Name: **204097-01\_RIG500\_QSG\_ww.indd Art**

Master Number: **204097-01**

Part Number: **204096-01**

Scale: **1:1**

Resolution: **300dp**

Placed Links:

Fonts: - - - Name: Gesta-Regular; Type: OpenType Type 1, Status: OK

- Name: RIGDisplay-Regular; Type: TrueType, Status: Embedded

- Name: RIGDisplay-Regular; Type: OpenType Type 1, Status: OK

- Name: Scout-Bold; Type: OpenType Type 1, Status: OK

- Name: Scout-Regular; Type: OpenType Type 1, Status: OK

Software: **CC 2014**

Printing Method: Offset lithography

Inks and Finishes:

(if applicable, include Cyan, Magenta, Yellow, Black)

**Pantone 172 C**

**Black**

Notes:

Original Designer: **Courtney Perry**

E-mail: **courtney.perry@plantronics.com**

Phone: **831-420-3024**

Revisions: E-mail:

Phone:

Changes to art after approval:

Dieline

Color

Photography

Text