

WEB MANUAL

EP 4



www.hertzaudiovideo.com

HERTZ
The Sound Experience

INPUTS

PRE IN Stereo

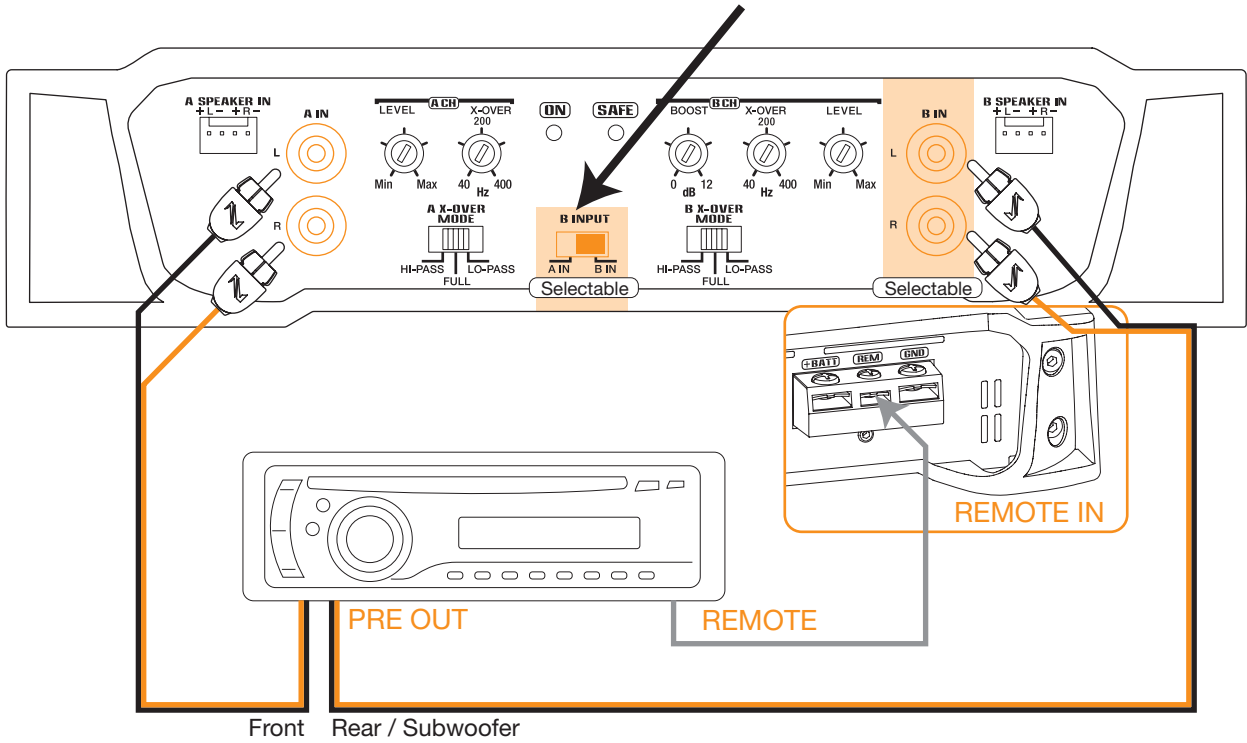

INPUTS

SPEAKER IN Stereo

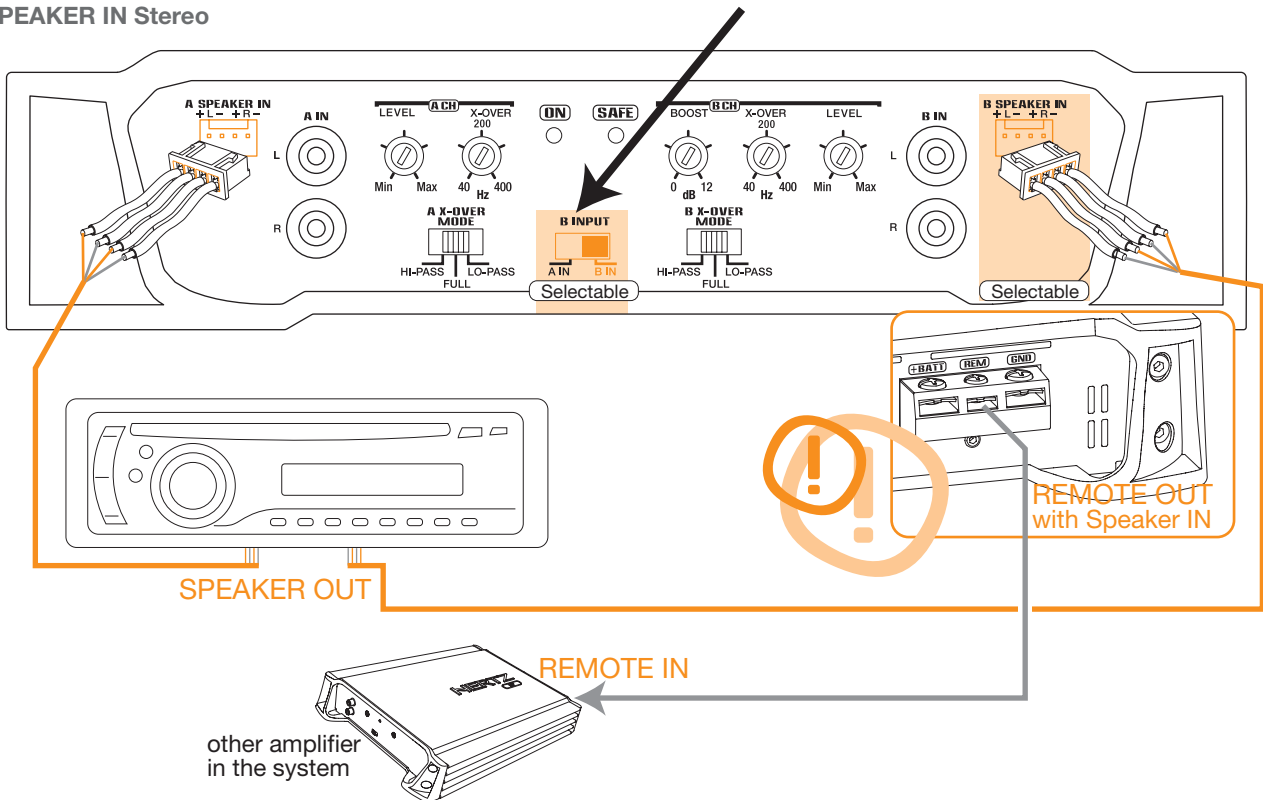

INPUTS

PRE IN Mono (2 Ch Mode)

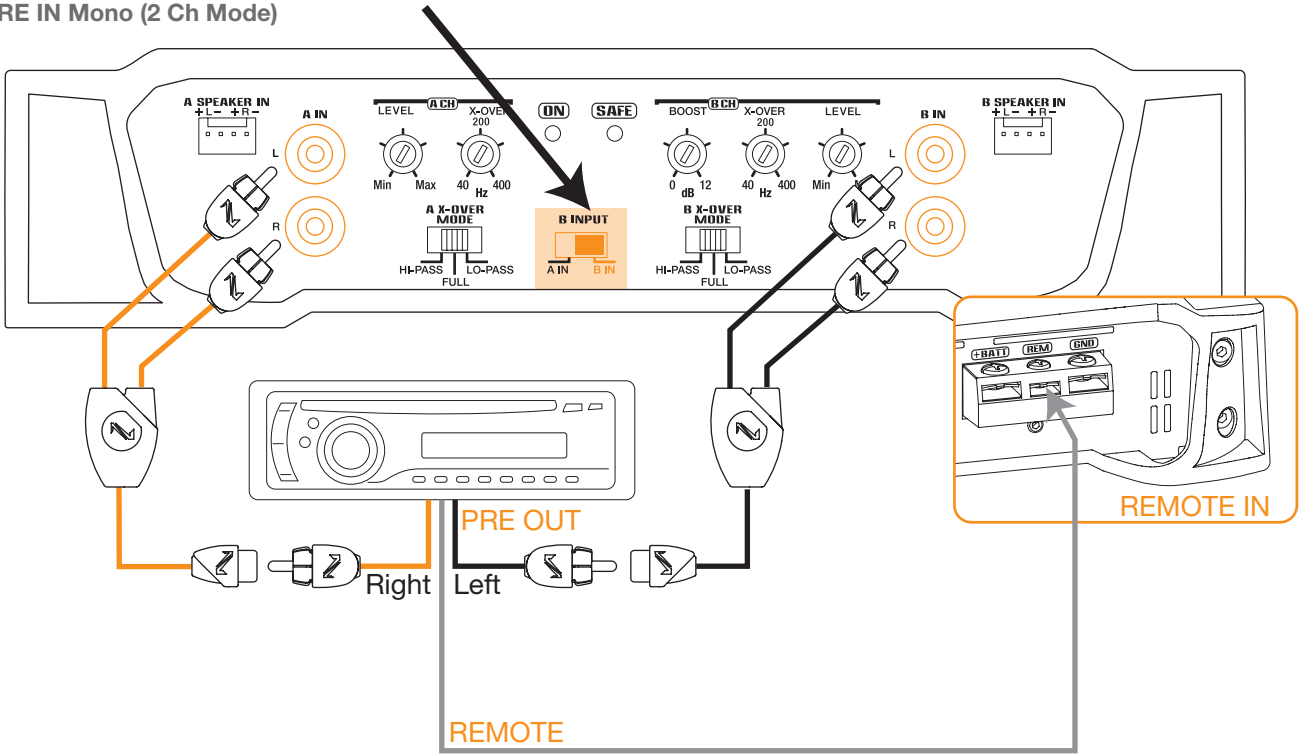

INPUTS

SPEAKER IN Mono (2Ch Mode)

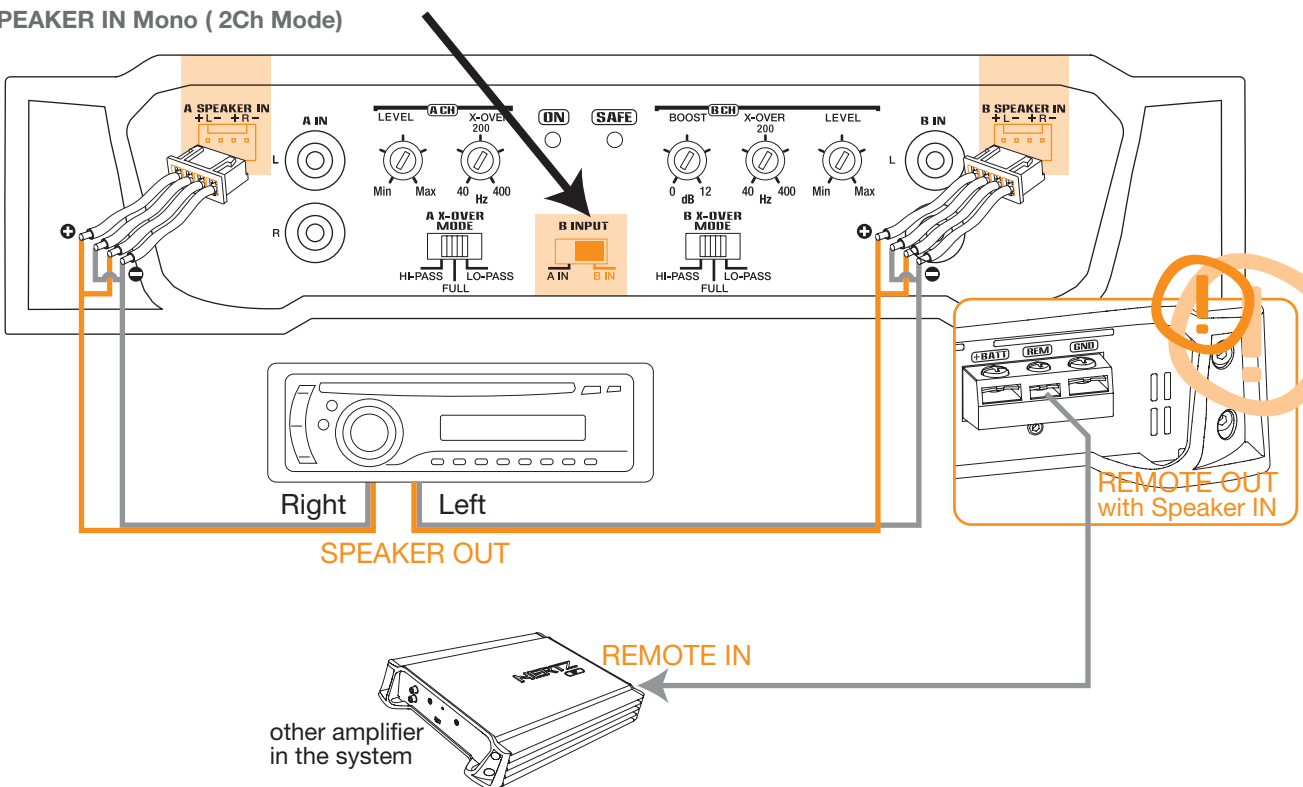

OUTPUTS

4 Channels Mode - Front / Rear

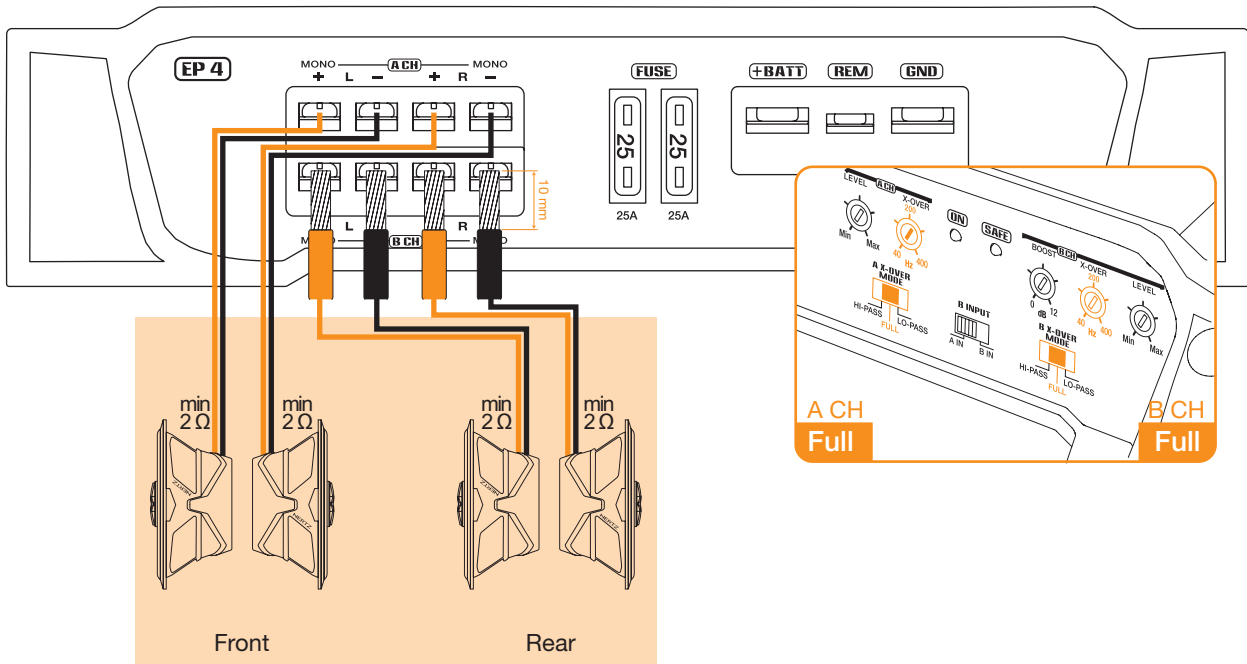

OUTPUTS

4 Channels Mode - Multichannel

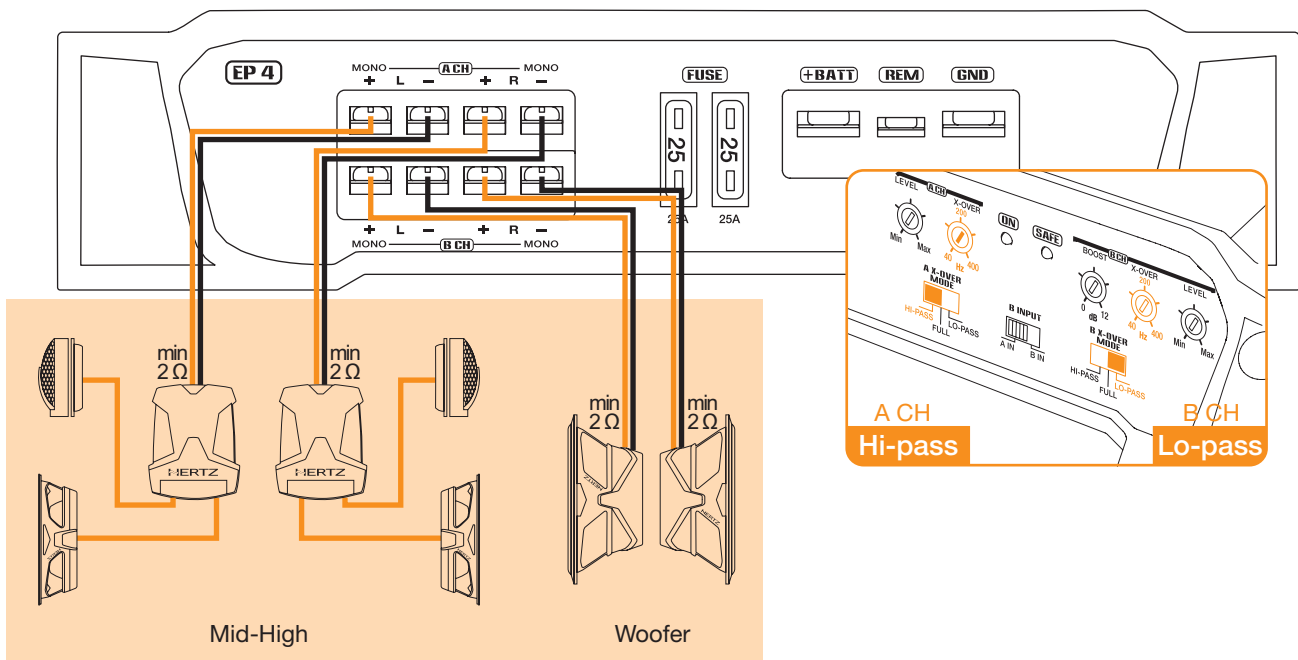

OUTPUTS

3 Channels Mode - Front-Sub

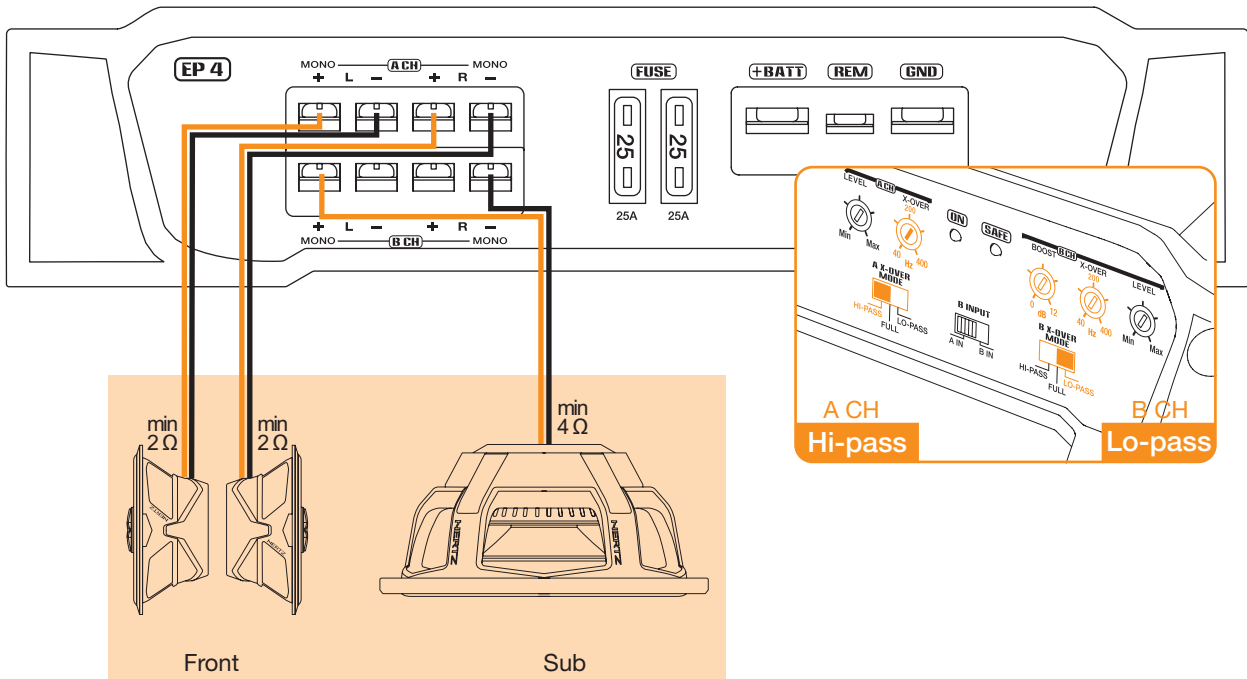

OUTPUTS

2 Channels Mode - Front

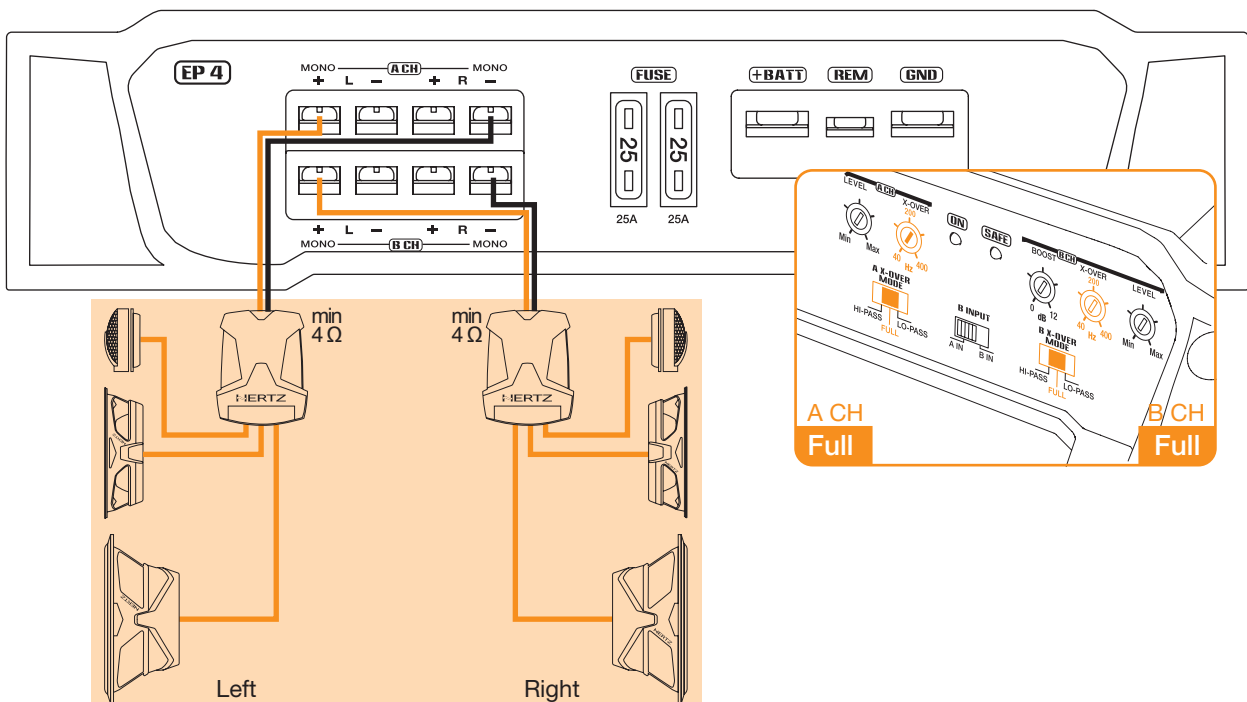



OUTPUTS

2 Channels Mode - Sub

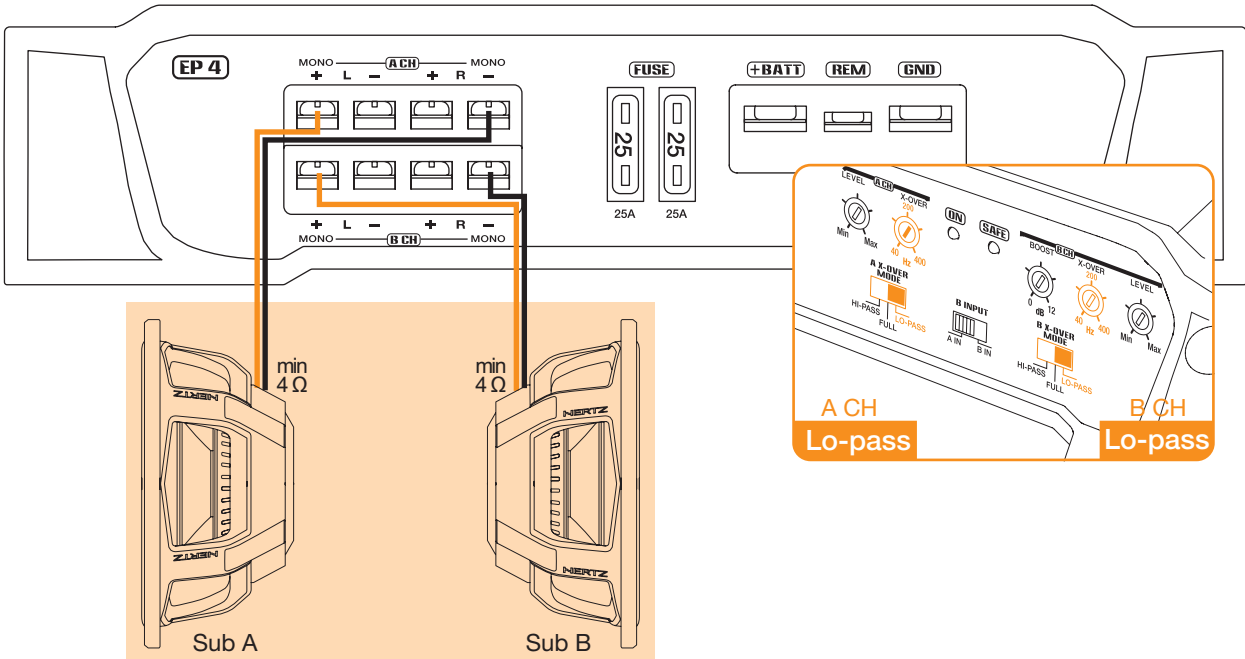

CONFIGURATION

Input configuration

Mode	Input	A Ch	B Ch
4 Ch		A IN	A IN
4 Ch		A IN	B IN
3 Ch A= stereo B= mono		A IN	Apply same L&R signal using RCA Y-adaptor
2 Ch		Apply same L&R signal using RCA Y-adaptor	Apply same L&R signal using RCA Y-adaptor

Filter configuration

Config.	A Ch	B Ch
1		
2		
3		
4		
5		
6		
7		
8		
9		

TECHNICAL SPECIFICATIONS

EP4

Power Supply	
Voltage	11±15 VDC
Minimum idling current	1 A
Idling current when off	0.02 mA
Consumption @ 2Ω; 14.4 VDC (MAX Musical Power)	28 A
Remote IN Voltage	6±15 VDC (1 mA)
Internal fuse	2 x 25 A

Amplifier stage	
Bandwidth (-3dB)	7÷60k Hz
Distortion - THD (1 kHz @ 4 Ω)	0.08%
S/N Ration (weighted A @ 1 V)	98 dB
Damping factor (1 kHz @ 4 Ω)	130
Input sensitive (PRE IN)	0.3÷5 V
Input sensitive (Speaker IN)	1.4±24 V
Input impedance (PRE IN)	15 kΩ
Input impedance (Speaker IN)	5 kΩ
Load impedance (MIN)	
4 Ch	2Ω
3 Ch	2 x 2Ω + 1 x 4Ω
2 Ch	4Ω
Output Power (RMS) @ 14.4 VDC; THD 1%	
4 Ch	60 W x 4 (4Ω)
4 Ch	95 W x 4 (2Ω)
3 Ch	60 W x 2 (4Ω) + 190 W x 1 (4Ω)
3 Ch	95 W x 2 (2Ω) + 190 W x 1 (4Ω)
2 Ch	190 W x 2 (4Ω)

Inputs / Outputs / Filters	
Input	PRE / Speaker
AMP Filter	
A Ch	Full / Hi-pass / Lo-pass 40÷400Hz@12dB/Oct.
B Ch	Full / Hi-pass / Lo-pass 40÷400Hz@12dB/Oct.
Bass Boost	B Channels 0 ÷ +12dB @ 45 Hz
Other Functions	
ART	Automatic Remote Turn-On/Off with Speaker-In

Size	
B x L x H mm	240 x 450 x 54
inches	9 ^{15/32} x 17 ^{23/32} x 2 ^{5/32}
Weight kg	4,80
lb	10.58